

TOOLS TO SUCCEED

INFINITY[®]
TOOL MFG.

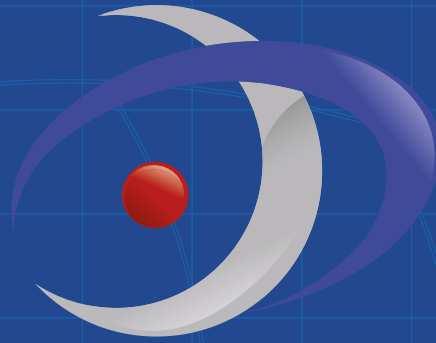

INFINITY[®]
TOOL MFG.

PRODUCT BROCHURE



CONTENTS.

Company Introduction	04
Key Headlines	06
Where we operate	07
Company profiles	08
Markets we serve	12
Products	14
Standard PDC Bits	16
Big Flush PDC Bits	17
Jetted PDC Bits	19
Rock Boss Extreme	21
Tricones	23
DTH Bits	24
Cable Tool Bits	26
Directional Hammer Bits	28
Drag Bits	29
Shark PDC Reamer	31
PDC Reamers	33
Tricone Hole Opener	34
Christmas Tree Hole Openers	36
DTH Hole Openers	37
Stabilizers	38
Subs	39
Appendix	40

AMERICAN MADE



TOUGH ROCK DRILLING TOOLS

Infinity Tool Mfg manufactures an industry-leading line of PDC Bits, PDC Reamers, horizontal directional drilling consumables and drilling accessories.

With our facility utilizing state-of-the art machinery, along with a combined experience of over 100 years in the drilling industry, Infinity takes that extra step in providing a top quality product.

QUALITY AT OUR HEART

Infinity is proud to be an ISO 9001:2015 accredited company. Achieving our ISO 9001:2015 certification means our customers have complete assurance that we manufacture to the highest quality standards. It also means that we continually strive to maintain and improve these standards that set us apart.

Our customers benefit by knowing they are working with an organization that follows an international standard, improving their service quality and making their clients a number one priority.

Infinity also continually improves our processes to ensure we identify all present customer needs and assess future requirements, as customer satisfaction has always been a fundamental part of our business.

We look forward to being of service to you and providing you with a premium quality product.



“THE
CUSTOMER
IS KING”

COMPANY INTRODUCTION

Since 2009, the name Infinity Tool Manufacturing has been synonymous with manufacturing and supplying industry-leading rock tools including down the hole bits, horizontal directional drilling consumables and drilling accessories, all of which are manufactured to ISO 9001 international quality management standard.

ABOUT US

The hub of our company is made up of a knowledgeable sales team both in-house and outside sales. They pride themselves on responding to all inquiries immediately and the team exceeds industry standards for service, utilizing the policy of 'the customer is king'.

Exceptional service and quality manufactured products made in the heart-land of America, we work closely with our customers to provide the best drilling solution to match their needs.

- **State-of-the-art engineering facility located in Benton, Illinois.**
- **High quality ISO 9001 manufactured product**
- **Premium quality sourcing and high volume supply of Tricone bits**
- **North American and International Sales and Technical Support**

KEY HEADLINES

Customer Support and Satisfaction is our key focus, when it comes to our product range, service, facilities and responsibilities.

MANUFACTURING FACILITY

Our state-of-the-art engineering facility is located in Benton, Illinois and can produce a high-performance product to any specification.

SERVICE & SUPPORT

Infinity has an outstanding Customer Service Support team who can be reached 24 hours a day, seven days a week.

QUALITY MANUFACTURING

Infinity is a registered ISO 9001 company ensuring products are manufactured to the highest quality standards.

CUSTOM PRODUCTS

In-house design and Engineering team to ensure products drill efficiently in our customer's ground conditions.



State-of-the-art
manufacturing facility



24 hours service
and support



High quality product -
ISO 9001:2015



Custom products available
for your ground conditions

WHERE WE OPERATE





KNOWLEDGEABLE SALES TEAM

All of us here at Infinity pride ourselves on exceptional service and quality manufactured Bits. We work closely with our customers to provide the best drilling tool solution to match their needs.

The hub of our company is made up of a knowledgeable Sales team both in-house and outside sales. They pride themselves on responding to all inquiries immediately and the team exceeds industry standards for service, utilizing the policy of 'the customer is king'.



IN-HOUSE ENGINEERING & DRAFTING TEAM

With our in house Engineering and Drafting team we are able to design and manufacture custom products and parts to our customers' exact specifications.

With the latest in machining technology we can make even the most complex designs a reality.

We are able to offer:

- CNC cut threads
- Long hole boring (up to 80")
- Custom engraving
- Turning (from 32" diameter to 120" long)
- Milling (from 32" diameter to 120" long)



STATE-OF-THE-ART ENGINEERING FACILITY

Our state-of-the-art engineering facility is located in Benton, Illinois and can produce a high performance product to any specification.

We have recently increased the footprint of our manufacturing plant. As a result of this we have been able to add several new machines to our facility, enabling us to double our manufacturing capacity. We are able to run most of our machines for 'lights out manufacturing', which enables us to keep manufacturing and energy costs low – a saving which we can then pass on to our customers – as well as meet tight deadlines.

The expansion and increased output of our manufacturing facility has allowed us to hire more professionals in a range of departments, from Sales all the way through to Upper Management, allowing an increased level of service to our clients.



SOURCING AND SUPPLY OF PREMIUM QUALITY TRICONE BITS

Infinity supplies an industry leading range of tricone bits benefiting from high performance and consistent quality throughout our range.

Sourcing high quality tricone bits enables our customers to tackle a wide range of ground conditions with over 700 roller cone bit designs.

Product is available from 2-15/16" diameter up to 36" with Milled Tooth and TCI inserts for drilling bore holes in different geological conditions.

Tricones are manufactured with API-7-1 certification and supported with a full quality management system.



CUSTOM PRODUCT DESIGN SERVICE

Our custom design service is available in order to guarantee that we supply products that maximize our customer's ROI.

This includes in-house Engineering and Drafting departments to ensure a fast turnaround from design to production.



PRODUCT REPAIR & REFURBISHMENT

To further maximize our customer's investment we also repair Rock Tools and Reamers, offering same-day estimates and one of the fastest turn-around times in the industry.

Rebuilding, as opposed to replacing, rock tools and reamers is a cost effective solution that will not only prove far cheaper than replacement but will greatly increase the life and return on investment too.



OUTSTANDING CUSTOMER SERVICE SUPPORT

Infinity has an outstanding Customer Service Support team who can be reached 24 hours a day, seven days a week.

Our customers can choose to speak to one of our team over the phone or, where required, we will not hesitate to send Technical Support Personnel to the drill site in order to overcome any issues. The Service team strive to enable our customers to resume their operations with as little time lost as possible.



QUALITY FOCUS

Infinity is proud to be an ISO 9001:2015 accredited company. Achieving ISO 9001:2015 certification means their customers have complete assurance that products are manufactured to the highest quality standards

Customers benefit by knowing they are working with an organization that follows an international standard, improving their service quality and making their clients a number one priority.

Infinity also continually improves their processes to ensure they identify all present customer needs and assess future requirements, as customer satisfaction has always been a fundamental part of their business.

MARKETS WE SERVE



OIL & GAS



**WATER WELL
& GEOTHERMAL**



HDD



MINING



GEOTECHNICAL



CONSTRUCTION

PDC BITS

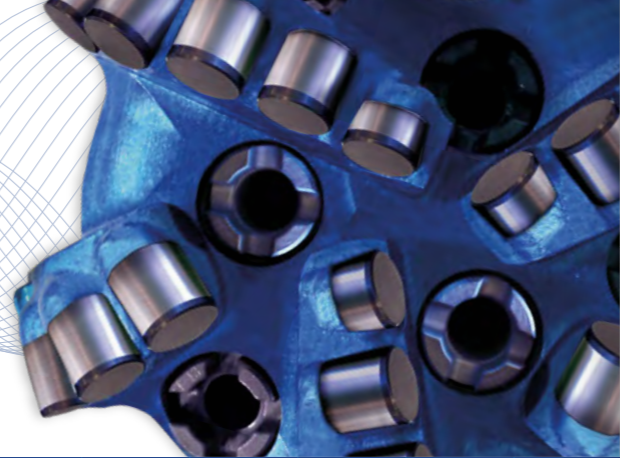

STANDARD



High quality PDC bits available in a range of options and sizes.

JETTED



A versatile PDC bit for smaller HDD rigs.

BIG FLUSH



Ideal for mixed ground conditions where high volume and low pressures are required

ROCK BOSS EXTREME



Specifically designed for HDD applications

PDC Drill Bits and Reamers are the next step to increase production in rock drilling and have been used with great success in the oil field. Recently it has become a go-to technology for many drillers in the Waterwell and HDD industry.

The primary reason for wanting to run PDC bits is increased production. When run to operating guidelines, a PDC bit can increase your penetration rate from anywhere between 50-250%. This translates to faster project completion, fuel savings and reduced labor costs per hole.

Another benefit of running PDC is how much less stress they place on drill rigs. They do not require the enormous amount of weight on bit that roller cones require, and as a general rule of thumb, PDC bits and reamers require less than half of the push/pull that a roller-cone would. Less torque means less stress and vibration on your drilling rods.

PDC products also have no moving parts and clean holes with a more consistent cutting size. In fact, Infinity's PDC bits are made from a one-piece steel body for strength and durability.

We are keen to offer advice, and help support your rock drilling challenges. To discuss operating procedures when using PDC bits or which products are best suited to your ground conditions, please get in touch with our customer service team.



5x faster than conventional methods



No moving parts

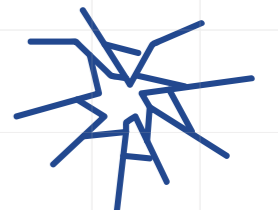

Less stress on the drill rig



Clean hole with consistent size



Manufactured in the USA



Repairable

FOR CUSTOM BUILDS PLEASE CONTACT US +1 618 439 4042

STANDARD PDC BITS

Standard PDC bits are good if you encounter a variety of ground conditions, from shale through to limestone. We manufacture all our PDC bits from a one-piece high grade alloy steel body for strength and durability.

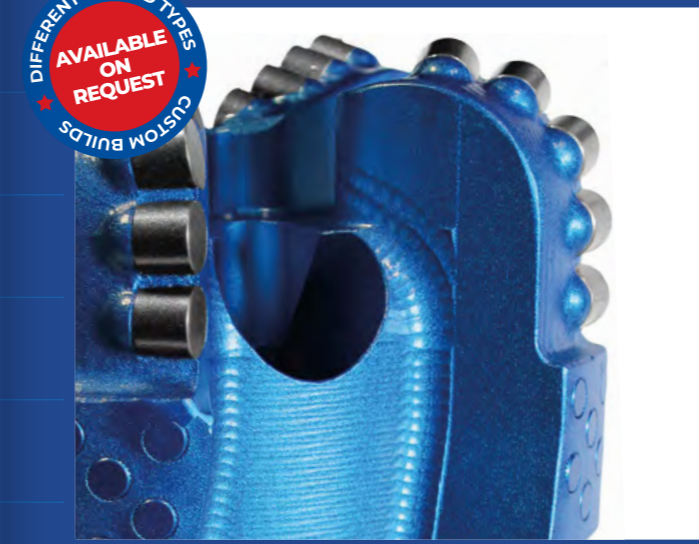

BIG FLUSH PDC BITS

Big Flush PDC Bits provide a high volume of drilling fluid at low pressures to give high performance in softer drilling conditions. Designed specifically for soft sand and shale Big Flush is ideally suited for Geo-Thermal and Waterwell drilling. These bits can also be used for Reverse Circulation applications.

Part Number	Diameter	Connection	Blades	Ports
ITM260675	1-15/16"	A ROD	2	2
ITM260674	1-15/16"	AW ROD	2	2
ITM260624	2-15/16"	N ROD 4	4	4
ITM260623	2-7/8"	N ROD 4	4	4
ITM260758	3-1/8"	N ROD 4	3	3
ITM260701	3-1/2"	N ROD 4	3	6
ITM260478	3-1/2"	2-3/8" API	3	3
ITM260538	3-5/8"	2-3/8" API	3	3
ITM260496	3-3/4"	2-3/8" API	3	3
ITM260553	3-7/8"	2-3/8" API	3	3
ITM260498	3-7/8"	2-3/8" API	5	5
ITM260499	4"	2-3/8" API	5	5
ITM260500	4-1/8"	2-3/8" API	5	5
ITM260501	4-1/4"	2-3/8" API	5	5
ITM260526	4-1/2"	2-3/8" API	3	3
ITM260502	4-1/2"	2-3/8" API	5	5
ITM260467	4-5/8"	2-7/8" API	4	3

Part Number	Diameter	Connection	Blades	Ports
ITM260645	2-15/16"	N ROD 4	3	3
ITM260706	2-7/8"	N ROD 4	3	3
ITM260716	3-1/4"	2-3/8" API	5	5
ITM260705	3-15/16	2-3/8" API	5	5
ITM260646	3-7/8"	2-3/8" API	3	3
ITM260670	4"	2-3/8" API	3	3
ITM260699	4"	2-3/8" API	4	4
ITM260630	4"	2-3/8" API	5	5
ITM260713	4-1/8"	2-3/8" API	4	4
ITM260759	4-1/8"	2-3/8" API	5	5
ITM260695	4-1/4"	2-3/8" API	3	3
ITM260669	4-1/4"	2-3/8" API	5	5
ITM260642	4-1/2"	2-3/8" API	5	5
ITM260648	4-3/4"	2-7/8" API	3	3
ITM260640	4-3/4"	2-7/8" API	5	5
ITM260632	4-7/8"	2-7/8" API	5	5
ITM260633	5"	2-7/8" API	5	5
ITM260717	5-1/8"	2-7/8" API	4	4
ITM260657	5-1/8"	2-7/8" API	5	5
ITM260634	5-1/4"	2-7/8" API	5	5
ITM260744	5-1/2"	2-7/8" API	4	4
ITM260635	5-1/2"	2-7/8" API	5	5
ITM260745	5-5/8"	2-7/8" API	4	4
ITM260637	5-5/8"	2-7/8" API	5	5
ITM260636	5-5/8"	3-1/2" API	5	5
ITM260671	5-7/8"	3-1/2" API	3	3
ITM260639	5-7/8"	3-1/2" API	5	5
ITM260631	6"	3-1/2" API	5	5
ITM260772	6-1/8"	3-1/2" API	5	5
ITM260768	6-1/4"	3-1/2" API	3	3
ITM260757	6-1/4"	3-1/2" API	4	4
ITM260747	6-1/4"	3-1/2" API	5	5
ITM260696	6-3/4"	3-1/2" API	5	5

DIFFERENT THREAD TYPES
AVAILABLE ON REQUEST
CUSTOM BUILDS



JETTED PDC BITS

Jetted PDC bits are manufactured with interchangeable jets. This allows control of the drilling fluid volume used to clean bit cutters and ensures maximum drilling efficiency.

Part Number	Diameter	Connection	Blades	Ports
ITM260702	7"	3-1/2" API	5	5
ITM260703	7"	3-1/2" API	6	6
ITM260689	7-5/8"	4-1/2" API	5	5
ITM260743	7-7/8"	3-1/2" API	5	5
ITM260688	7-7/8"	4-1/2" API	5	5
ITM260694	8"	4-1/2" API	5	5
ITM260647	8-1/2"	4-1/2" API	5	5
ITM260687	9"	4-1/2" API	5	5
ITM260728	9-1/4"	4-1/2" API	6	6
ITM260712	9-7/8"	4-1/2" API	5	7
ITM260718	9-7/8"	6 5/8" API	5	7
ITM260704	9-7/8"	6-5/8" API	6	6

Part Number	Diameter	Connection	Blades	Ports	Backouts	Shock Studs
ITM260658	4-1/2"	2-7/8" API	5	5		
ITM260659	4-1/2"	2-7/8" API	5	5		
ITM260649	4-3/4"	2-7/8" API	3	3		
ITM260650	4-3/4"	2-7/8" API	5	5		
ITM260664	4-3/4"	2-7/8" API	5	5	Y	
ITM260755	5-3/8"	2-7/8" API	5	5		
ITM260663	5-1/2"	2-7/8" API	5	5	Y	
ITM260667	5-1/2"	2-7/8" API	5	5		
ITM260484	5-1/2"	3-1/2" API	5	5	Y	
ITM260508	5-1/2"	3-1/2" API	5	5		
ITM260610	5-1/2"	3-1/2" API	6	6		
ITM260644	5-5/8"	3-1/2" API	5	5		
ITM260668	5-5/8"	3-1/2" API	6	6		
ITM260643	5-3/4"	3-1/2" API	5	5		
ITM260612	5-3/4"	3-1/2" API	6	6		
ITM260489	5-7/8"	3-1/2" API	5	5		
ITM260679	5-7/8"	3-1/2" API	6	6		
ITM260491	6"	3-1/2" API	5	5		
ITM260749	6"	2-7/8" API	6	6		
ITM260528	6"	3-1/2" API	6	6		
ITM260613	6-1/8"	3-1/2" API	3	3		
ITM260479	6-1/8"	3-1/2" API	5	5		
ITM260596	6-1/8"	3-1/2" API	5	5	Y	
ITM260567	6-1/8"	3-1/2" API	6	6		
ITM260622	6-1/4"	3-1/2" API	4	4		
ITM260474	6-1/4"	3-1/2" API	5	5		
ITM260512	6-1/4"	3-1/2" API	5	5	Y	
ITM260660	6-1/4"	3-1/2" API	6	6		
ITM260690	6-1/4"	3-1/2" API	6	6	Y	Y
ITM260710	6-1/4"	3-1/2" API	6	6	Y	
ITM260532	6-1/2"	3-1/2" API	3	3		
ITM260483	6-1/2"	3-1/2" API	5	5	Y	

Part Number	Diameter	Connection	Blades	Ports	Backouts	Shock Studs
ITM260509	6-1/2"	3-1/2" API	5	5		
ITM260552	6-1/2"	3-1/2" API	6	6		
ITM260722	6-1/2"	3-1/2" API	6	6	Y	
ITM260731	6-3/4"	3-1/2" API	5	5		
ITM260734	6-3/4"	3-1/2" API	5	5	Y	
ITM260451	6-3/4"	3-1/2" API	6	6		
ITM260520	7-1/4"	3-1/2" API	5	5		
ITM260676	7-1/2"	3-1/2" API	5	5		
ITM260677	7-1/2"	4-1/2" API	5	5		
ITM260476	7-7/8"	4-1/2" API	5	5		
ITM260468	7-7/8"	4-1/2" API	6	6	Y	
ITM260510	8-1/2"	4-1/2" API	5	5	Y	Y
ITM260534	8-1/2"	4-1/2" API	6	6		
ITM260575	8-1/2"	4-1/2" API	8	8		
ITM260511	8-3/4"	4-1/2" API	5	5		
ITM260547	8-3/4"	4-1/2" API	5	5		Y
ITM260446	8-3/4"	4-1/2" API	6	6	Y	
ITM260603	8-3/4"	4-1/2" API	6	6		
ITM260700	8-3/4"	4-1/2" API	6	6	Y	Y
ITM260614	9-7/8"	6-5/8" API	3	6		
ITM260463	9-7/8"	6-5/8" API	5	7		
ITM260485	9-7/8"	6-5/8" API	6	9	Y	
ITM260523	9-7/8"	6-5/8" API	6	9		
ITM260609	9-7/8"	6 5/8" API	7	10		
ITM260592	10-5/8"	6-5/8" API	5	7		
ITM260472	10-5/8"	6-5/8" API	6	6		
ITM260666	10-5/8"	6-5/8" API	6	6	Y	
ITM260481	10-5/8"	6-5/8" API	7	10		
ITM260654	11"	6 5/8" API	5	7		
ITM260460	11"	6 5/8" API	6	6		
ITM260555	11-3/4"	6-5/8" API	6	6		
ITM260549	11-7/8"	6-5/8" API	5	7		
ITM260707	11-7/8"	6-5/8" API	6	6		
ITM260548	12"	4-1/2" API	6	6		
ITM260564	12-1/4"	6-5/8" API	5	7		
ITM260765	12-1/4"	6-5/8" API	5	7	Y	Y
ITM260497	12-1/4"	6-5/8" API	6	6	Y	
ITM260422	12-1/4"	6-5/8" API	6	6	Y	
ITM260486	12-1/4"	6-5/8" API	6	6		
ITM260487	12-1/4"	6 5/8" API	8	8		
ITM260490	12-1/2"	6-5/8" API	8	8		
ITM260619	13-1/2"	6-5/8" API	6	9		
ITM260566	14"	6-5/8" API	6	6		
ITM260452	14-3/4"	7-5/8" API	6	9		
ITM260569	15"	7-5/8" API	5	7		
ITM260572	16"	7-5/8" API	6	9		
ITM260518	17"	7-5/8" API	6	9		
ITM260437	17-1/2"	7-5/8" API	5	8	Y	
ITM260727	17-1/2"	7-5/8" API	5	7		
ITM260477	17-1/2"	7-5/8" API	6	9	Y	

DIFFERENT THREAD TYPES AVAILABLE ON REQUEST CUSTOM BUILDS



ROCK BOSS EXTREME BITS

Specifically designed for HDD applications, the Rock Boss Extreme is one of the most steerable rock bits on the market, manufactured with back out cutters through the entire range.

Part Number	Diameter	Connection	Blades	Ports	Backouts	Shock Studs
ITM260736	5"	2-7/8" API	5	5	Y	
ITM260729	5-1/2"	2-7/8" API	5	5	Y	
ITM260731	5-1/2"	2-7/8" API	6	3	Y	
ITM260754	6-1/4"	3-1/2" API	5	5	Y	
ITM260730	6-1/2"	3-1/2" API	5	5	Y	
ITM260751	6-3/4"	3-1/2" API	5	5	Y	

PDC & REAMER REPAIR

NO NEED TO REPLACE REPAIR

A COST-EFFECTIVE SOLUTION



BEFORE



Rebuilding, as opposed to replacing, your PDC bits and reamers is a cost-effective solution that will not only prove far cheaper than replacement, but will greatly increase the life of your tool and as a result, your return on investment too.

It goes without saying that a well-maintained tool will offer better performance, and as such will require less time and money to operate.

All repairs are undertaken by us in our facility in Illinois, and all replacement parts are American made to ensure quality and durability.

AFTER



INCREASE THE LIFE OF YOUR TOOL

We repair all makes and models of pdc bits and reamers, with our turn-around time being one of the fastest in the industry.

CONTACT US:

All we need are some high quality photos of your worn bit, including various angles, and we can give you an estimate the same day.

1-888-838-6657
(+1) 618 439 4042 (International)

sales@infinitytoolmfg.com
www.infinitytoolmfg.com



TRICONES

Infinity supplies an industry leading range of tricone bits benefiting from high performance and consistent quality throughout our range.

Sourcing high quality tricone bits enables our customers to tackle a wide range of ground conditions with over 700 roller cone bit designs.

Product is available from 2-15/16" diameter up to 36" with Milled Tooth and TCI inserts for drilling bore holes in different geological conditions.

Tricones are manufactured with API-7-1 certification and supported with a full quality management system.

Size Inch	Open Bearing		Sealed Roller Bearing	
	Mill-tooth	Button TCI	Mill-tooth	Button TCI
Part Number				
2-15/16"	-	36428	-	-
3-7/8"	-	36364	-	-
4-1/4"	36406	36407	-	-
4-3/4"	-	-	-	36433
4-7/8"	36408	36409	-	36434
5-1/4"	-	36383	-	-
5-1/2"	36332	36335	36424	36379
5-5/8"	36321	36333	-	36360
5-7/8"	-	36453	-	36432
6"	36431	36380	36443	36442
6-1/8"	-	-	-	36402
6-1/4"	36320	36334	36414	36403
6-1/2"	36400	-	36416	36417
6-3/4"	-	36343	-	36385
7-1/2"	-	-	36418	36419
7-7/8"	-	-	36420	36401
8-1/2"	-	-	-	36261
9-7/8"	-	-	36445	36297
10-1/4"	36422	-	-	-
10-5/8"	36435	-	36441	36437
11-5/8"	-	-	-	36452
12-1/4"	36436	-	36440	36361
12-3/4"	-	-	36426	36430
14-3/4"	-	-	36427	36448
15-1/2"	-	-	36455	36456
16-1/2"	-	-	36457	36459
17-1/2"	36454	-	36460	36461
18"	-	-	36447	-

FOR CUSTOM BUILDS PLEASE CONTACT US +1 618 439 4042

DTH BITS

We custom make DTH bits that are suited to drilling for Oil & Gas, Geo- Thermal & Waterwell, Construction, Horizontal Directional Drilling as well as Mining. Bit diameters range from 2" to 18", in four different face shapes with an excellent selection of industry shanks.



Shank	Diameter Range	Face Shape				Carbide Stocked	Carbide Special Order	
		Concave	Convex	Flat	Double Gauge		Standard	Diamond
2" RANGE								
Dominator 100	2" to 3-1/2"	●	●	●	●	●	●	●
3" RANGE								
IR 3.5	3-1/2" to 4-3/4"	●	●	●	●	●	●	●
BR 2	2-3/4" to 4-3/4"	●	●	●	●	●	●	●
Cop 32	3-1/2" to 4-3/4"	●	●	●	●	●	●	●
Mach 33	3-1/2" to 4-3/4"	●	●	●	●	●	●	●
Mission 3	3-1/2" to 4-3/4"	●	●	●	●	●	●	●
4" RANGE								
340	4" to 5-3/4"	●	●	●	●	●	●	●
SD4 / 34-15	4" to 5-3/4"	●	●	●	●	●	●	●
QL40	4" to 5-3/4"	●	●	●	●	●	●	●
Mission 4	4" to 5-3/4"	●	●	●	●	●	●	●
Mach 40	4" to 5-3/4"	●	●	●	●	●	●	●
TD40 / QLX40	4" to 5-3/4"	●	●	●	●	●	●	●
RC400	4" to 5-3/4"	●	●	●	●	●	●	●
RC475	4" to 5-3/4"	●	●	●	●	●	●	●
5" RANGE								
350	5" to 5-3/4"	●	●	●	●	●	●	●
SD5 / 43-15	5" to 5-3/4"	●	●	●	●	●	●	●
QL50	5" to 6-3/4"	●	●	●	●	●	●	●
Mission 5	5" to 6-3/4"	●	●	●	●	●	●	●
6" RANGE								
360	5-7/8" to 10"	●	●	●	●	●	●	●
SD6 / 53-15	5-7/8" to 10"	●	●	●	●	●	●	●
QL60	5-7/8" to 10"	●	●	●	●	●	●	●
Mission 6	5-7/8" to 10"	●	●	●	●	●	●	●

Shank	Diameter Range	Face Shape				Carbide Stocked	Carbide Special Order	
		Concave	Convex	Flat	Double Gauge		Standard	Diamond
8" RANGE								
380	7-1/2" to 12-1/4"	●	●	●	●	●	●	●
SD8 / 63-15	7-1/2" to 12-1/4"	●	●	●	●	●	●	●
QL80	7-1/2" to 12-1/4"	●	●	●	●	●	●	●
10" RANGE								
SD10	9-7/8" to 12-7/8"	●	●	●	●	●	●	●
12" RANGE								
DHD112	11-7/8" to 18"	●	●	●	●	●	●	●
SD12	11-7/8" to 18"	●	●	●	●	●	●	●
QL120	11-7/8" to 18"	●	●	●	●	●	●	●

HOW TO ORDER YOUR DTH BIT

1. Select Your Shank
2. Select the Diameter(s) of the bits you require
3. Select the Face Shape - Concave / Convex / Flat / Double Gauge
4. Select your carbide design - Ballistic / Semi Ballistic / Domed / Diamond / Bluemaxx

CABLE TOOL BITS

We custom make Cable Tool bits that are suited to a wide variety of applications, in either flat faced designs, drop center designs or a design for soft rock.

Bit diameters range from 3-7/8" to 10".



Part Number	Size	Type	Connection
ITM700025	3-7/8"	Flat Face	1-1/2" X 2-1/4" - 8
ITM700029	3-15/16"	Flat Face	1-1/2" X 2-1/4" - 8
ITM700007	4"	Flat Face	1-1/2" X 2-1/4" - 8
ITM700017	4-3/4"	Flat Face	2" X 3" - 7
ITM700018	4-3/4"	Drop Center	2" X 3" - 7
ITM700026	4-3/4"	Drop Center	2" X 3" - 7
ITM700040	4-3/4"	Flat Face	1-5/8" X 2-5/8" - 7
ITM700019	4-7/8"	Drop Center	2" X 3" - 7
ITM700020	4-7/8"	Flat Face	1-5/8" X 2-5/8" - 7
ITM700031	4-7/8"	Flat Face	2-1/4" X 3-1/4" - 7
ITM700039	4-7/8"	Flat Face	2" X 3" - 7
ITM700035	5"	Flat Face	2" X 3" - 7
ITM700002	5-1/2"	Drop Center	2" X 3" - 7
ITM700014	5-5/8"	Flat Face	2" X 3" - 7
ITM700032	5-5/8"	Flat Face	2-1/4" X 3-1/4" - 7
ITM700009	5-7/8"	Drop Center	2" X 3" - 7
ITM700023	5-1/8"	Flat Face	2-1/4" X 3-1/4" - 7
ITM700022	6"	Flat Face	2" X 3" - 7
ITM700006	6"	Flat Face	2-1/4" X 3-1/4" - 7
ITM700011	6"	Drop Center	2" X 3" - 7
ITM700010	6"	Drop Center	2-1/4" X 3-1/4" - 7
ITM700008	6-1/8"	Flat Face	2" X 3" - 7
ITM700003	6-1/8"	Flat Face	2-1/4" X 3-1/4" - 7
ITM700005	6-1/8"	Drop Center	2" X 3" - 7
ITM700028	6-1/8"	Drop Center	2-1/4" X 3-1/4" - 7
ITM700027	6-1/8"	SR	2-1/4" X 3-1/4" - 7
ITM700004	6-1/4"	Drop Center	2" X 3" - 7
ITM700013	6-1/4"	Flat Face	2" X 3" - 7
ITM700033	6-3/4"	Flat Face	2-1/4" X 3-1/4" - 7

Part Number	Size	Type	Connection
ITM700024	7-7/8"	Flat Face	2-1/4" X 3-1/4" - 7
ITM700012	7-7/8"	Flat Face	2-3/4" X 3-3/4" - 7
ITM700015	8"	Drop Center	2" X 3" - 7
ITM700036	8"	Z Face	2" X 3" - 7
ITM700001	8-3/4"	Flat Face	2-3/4" X 3-3/4" - 7
ITM700016	8-3/4"	Drop Center	2" X 3" - 7
ITM700021	9-7/8"	Drop Center	2-3/4" X 3-3/4" - 7
ITM700038	10-1/8"	Drop Center	2-3/4" X 3-3/4" - 7
ITM700037	10"	Z Face	2" X 3" - 7
ITM700030	11-1/2"	Flat Face	3-1/4" X 4-1/4" - 7

DIRECTIONAL HAMMER BITS



DRAG BITS

We custom make Drag bits that are suited for Oil & Gas, Geo-Thermal & Waterwell, Construction, Horizontal Directional Drilling and Mining.

With a large range of bit diameters and other customizable options, we really can produce a Drag bit to meet your needs.

Part Number	Shank	Diameter	Face Design
ITM280001	HDD30	4-1/4"	Convex
ITM650001	HDD40	4-1/4"	Convex
ITM650002	HDD40	4-1/4"	Slant Face
ITM650008	HDD40	4-1/2"	Slant Face
ITM650007	HDD40	5"	Convex
ITM650005	HDD40	5-1/4"	Slant Face
ITM360008	HDD50	5"	Convex
ITM360004	HDD50	5-1/4"	Slant Face
ITM360007	HDD50	5-1/4"	Convex
ITM360015	HDD50	5-1/2"	Slant Face
ITM360014	HDD50	5-3/4"	Slant Face
ITM360017	HDD50	6-1/4"	Slant Face
ITM360016	HDD50	6-1/4"	Slant Face
ITM090968	QL50/HDD60	6-1/8"	Convex
ITM090042	QL50/HDD60	6-1/8"	Slant Face
ITM090074	QL50/HDD60	6-1/4"	Convex
ITM090024	QL50/HDD60	6-1/4"	Slant Face
ITM090061	QL50/HDD60	6-1/2"	Slant Face
ITM090076	QL50/HDD60	6-3/4"	Slant Face
ITM090077	QL50/HDD60	6"	Slant Face
ITM090086	QL50/HDD60	6"	Slant Face
ITM090088	QL50/HDD60	7-1/2"	Convex
ITM090089	QL50/HDD60	7-1/2"	Convex
ITM550004	HDD70	7-1/4"	Convex
ITM550005	HDD70	7-1/2"	Slant Face
ITM550006	HDD70	8-1/4"	Convex
ITM550007	HDD70	8-1/2"	Slant Face

Short Step Bits 2-3/8" API

Diameter (in)	Description
3"	Short Step, 2 Step, 3 Wing, 2-3/8" API
3-1/2"	Short Step, 2 Step, 3 Wing, 2-3/8" API
3-5/8"	Short Step, 2 Step, 3 Wing, 2-3/8" API
3-7/8"	Short Step, 2 Step, 3 Wing, 2-3/8" API
4"	Short Step, 3 Step, 3 Wing, 2-3/8" API
4-1/8"	Short Step, 3 Step, 3 Wing, 2-3/8" API
4-1/4"	Short Step, 3 Step, 3 Wing, 2-3/8" API
4-1/2"	Short Step, 3 Step, 3 Wing, 2-3/8" API
4-3/4"	Short Step, 3 Step, 3 Wing, 2-3/8" API
4-7/8"	Short Step, 3 Step, 3 Wing, 2-3/8" API
5"	Short Step, 3 Step, 3 Wing, 2-3/8" API
5-1/8"	Short Step, 3 Step, 3 Wing, 2-3/8" API
5-1/4"	Short Step, 3 Step, 3 Wing, 2-3/8" API
5-3/8"	Short Step, 3 Step, 3 Wing, 2-3/8" API
5-1/2"	Short Step, 3 Step, 3 Wing, 2-3/8" API
5-5/8"	Short Step, 3 Step, 3 Wing, 2-3/8" API
5-7/8"	Short Step, 4 Step, 3 Wing, 2-3/8" API
6"	Short Step, 4 Step, 3 Wing, 2-3/8" API
6-1/8"	Short Step, 4 Step, 3 Wing, 2-3/8" API
6-1/4"	Short Step, 4 Step, 3 Wing, 2-3/8" API
6-1/2"	Short Step, 4 Step, 3 Wing, 2-3/8" API
6-3/4"	Short Step, 4 Step, 3 Wing, 2-3/8" API
7"	Short Step, 5 Step, 3 Wing, 2-3/8" API

Short Chevron Bits 2-3/8" API

3-1/2"	Short Chevron, 3 Wing, 2-3/8" API
3-7/8"	Short Chevron, 3 Wing, 2-3/8" API
4"	Short Chevron, 3 Wing, 2-3/8" API
4-1/8"	Short Chevron, 3 Wing, 2-3/8" API
4-1/4"	Short Chevron, 3 Wing, 2-3/8" API
4-1/2"	Short Chevron, 3 Wing, 2-3/8" API
4-3/4"	Short Chevron, 3 Wing, 2-3/8" API
5"	Short Chevron, 3 Wing, 2-3/8" API
5-1/8"	Short Chevron, 3 Wing, 2-3/8" API

Diameter (in)	Description
5-1/4"	Short Chevron, 3 Wing, 2 3/8" API
5-1/2"	Short Chevron, 3 Wing, 2 3/8" API
5-5/8"	Short Chevron, 3 Wing, 2 3/8" API
5-7/8"	Short Chevron, 3 Wing, 2 3/8" API

Large Step Bits 3-1/2" API

5-7/8"	Large Step, 3 Step, 3 Wing, 3-1/2 API
6"	Large Step, 3 Step, 3 Wing, 3-1/2 API
6-1/4"	Large Step, 3 Step, 3 Wing, 3-1/2 API
6-1/2"	Large Step, 3 Step, 3 Wing, 3-1/2 API
6-3/4"	Large Step, 3 Step, 3 Wing, 3-1/2 API
7"	Large Step, 4 Step, 3 Wing, 3-1/2 API
7-1/8"	Large Step, 4 Step, 3 Wing, 3-1/2 API
7-3/8"	Large Step, 4 Step, 3 Wing, 3-1/2 API
7-1/2"	Large Step, 4 Step, 3 Wing, 3-1/2 API
7-3/4"	Large Step, 4 Step, 3 Wing, 3-1/2 API
7-7/8"	Large Step, 4 Step, 3 Wing, 3-1/2 API
8"	Large Step, 5 Step, 3 Wing, 3-1/2 API
8-1/4"	Large Step, 5 Step, 3 Wing, 3-1/2 API
8-1/2"	Large Step, 5 Step, 3 Wing, 3-1/2 API
8-3/4"	Large Step, 5 Step, 3 Wing, 3-1/2 API
9"	Large Step, 6 Step, 3 Wing, 3-1/2 API
9-1/4"	Large Step, 6 Step, 3 Wing, 3-1/2 API
9-1/2"	Large Step, 6 Step, 3 Wing, 3-1/2 API
9-3/4"	Large Step, 6 Step, 3 Wing, 3-1/2 API
9-7/8"	Large Step, 6 Step, 3 Wing, 3-1/2 API
10"	Large Step, 7 Step, 3 Wing, 3-1/2 API
10-1/2"	Large Step, 7 Step, 3 Wing, 3-1/2 API
10-3/4"	Large Step, 7 Step, 3 Wing, 3-1/2 API
11"	Large Step, 7 Step, 3 Wing, 3-1/2 API
12"	Large Step, 7 Step, 3 Wing, 3-1/2 API

Large Chevron 3-1/2" API

5-7/8"	Large Chevron, 3 Wing, 3-1/2 API
6"	Large Chevron, 3 Wing, 3-1/2 API

SHARK PDC REAMER

Shark PDC Reamer - Revolutionary new PDC Rock Reamer with Replaceable Cutters

Ferocious power and a never ending supply of teeth, we are not talking about a Great White here, but Infinity's new Shark PDC Reamer.

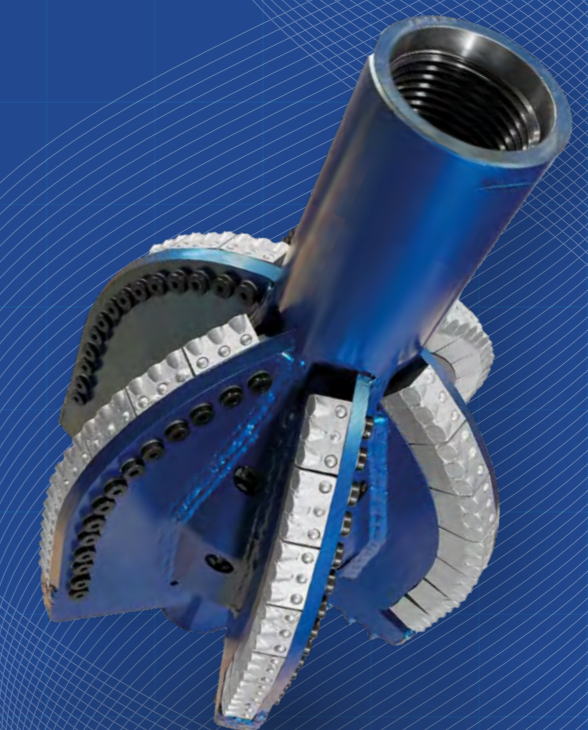

The new reamer was born out a simple concept, to enable a rapid change of cutters onsite, minimizing down time. The bottom line, no more sending reamers in for repair or buying new. Fit a new segment and be back up and running in minutes.

Each cutter segment is installed with hand tools, maximizing reaming time and minimizing cost. Additionally every segment has the same design...

.. no matter which position on the reamer blade...

... no matter what size of reamer.

Large Chevron 3 1/2 " API	
Diameter (in)	Description
6-1/4"	Large Chevron, 3 Wing, 3 1/2 API
6-1/2"	Large Chevron, 3 Wing, 3 1/2 API
6-6/4"	Large Chevron, 3 Wing, 3 1/2 API
7"	Large Chevron, 3 Wing, 3 1/2 API
7-1/8"	Large Chevron, 3 Wing, 3 1/2 API
7-1/2"	Large Chevron, 3 Wing, 3 1/2 API
7-7/8"	Large Chevron, 3 Wing, 3 1/2 API
8"	Large Chevron, 3 Wing, 3 1/2 API
8-1/2"	Large Chevron, 3 Wing, 3 1/2 API
G. N-Rod Step Bits	
2-7/8"	N-Rod Step Bit, 1 Step, 3 Wing
2-15/16"	N-Rod Step Bit, 1 Step, 3 Wing
3"	N-Rod Step Bit, 1 Step, 3 Wing
3-1/2"	N-Rod Step Bit, 2 Step, 3 Wing
H. N-Rod Chevron Bits	
2-7/8"	N-Rod Chevron, 3 Wing
2-15/16"	N-Rod Chevron, 3 Wing
3"	N-Rod Chevron, 3 Wing
3-1/2"	N-Rod Chevron, 3 Wing
I. Claw Bits	
4-1/2" - 5-1/8"	Claw Bit Body w/Cutters & Pilots 2 3/8 API
5-7/8" - 6-3/4"	Claw Bit Body w/Cutters & Pilots 3 1/2 API
7 - 7-1/2"	Claw Bit Body w/Cutters & Pilots 3 1/2 API
8"-9"	Claw Bit Body w/Cutters & Pilots 3 1/2 API

Here are some of the other features of our new reamer:



Replaceable cutter segments supplied in kit form with everything you need to replace a segment.



All cutter segments are interchangeable no matter which position they are required on the blade.

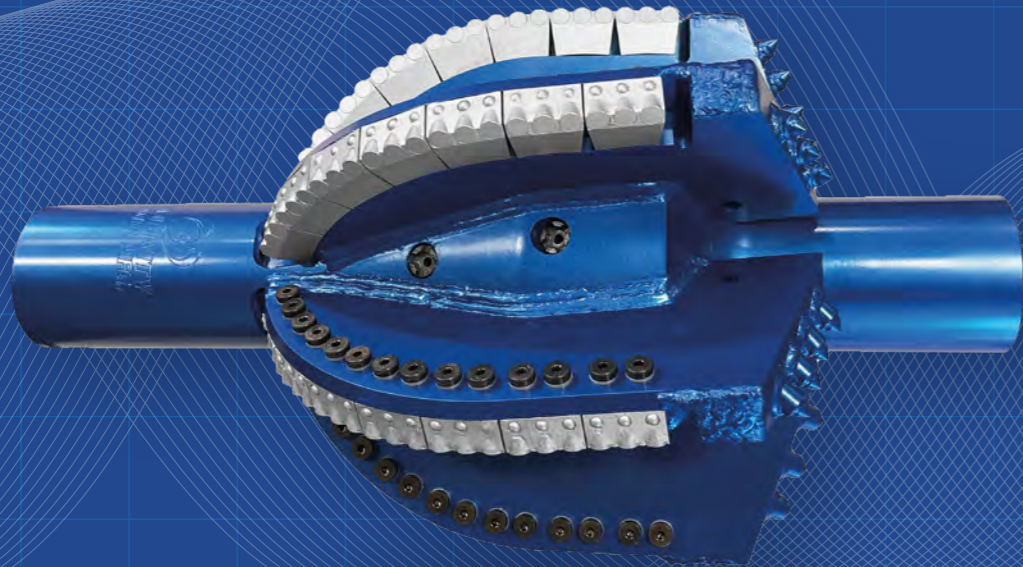

Cutters are designed to be changed onsite with hand tools

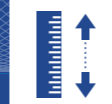

Cutter segments are the same no matter what size of reamer.

Our Shark PDC Reamer also benefits from our unique design, covered by an international patent with the following benefits:

- Increased penetration rates for faster project completion - up to 5 times faster than conventional methods.
- Reaming up to 12" extra diameter in 1 pass (e.g. 6" pilot to 18")
- Less stress on the drill rig - lower torque required and less vibration on the rods
- No moving parts for increased reliability
- Clean holes with a consistent size.



PDC REAMERS

SIZE (Reaming size x min pilot hole size)	Thread	Number of Blades	Blades Replaceable	Steel Shank	Back out Cutters	Push/ Pull	Replaceable Teeth Option (Shark)
5-1/2" x 3-3/4"	2-3/8" Reg Box-box	5	NO	YES	YES	Pull Only	NO
6-1/4" x 3-3/4"	2-3/8 Reg Box-box	5	NO	YES	YES	Pull Only	NO
6-3/4" x 4-1/2"	2-7/8 Reg Box-box	5	NO	YES	YES	Pull Only	NO
8" x 5"	2-3/8" Reg Box-box	5	NO	YES	YES	Pull And Push	NO
10" x 5"	2-7/8" If Box-box	5	NO	YES	YES	Pull And Push	NO
12" x 5"	2-7/8" If Box-box	5	NO	YES	YES	Pull And Push	NO
14" x 6"	3-1/2" If Box-box	5	YES	YES	YES	Pull And Push	YES
16" x 6"	3-1/2" If Box-box	6	YES	YES	YES	Pull And Push	YES
18" x 6"	3-1/2" If Box-box	6	YES	YES	YES	Pull And Push	YES
20" x 6"	3-1/2" If Box-box	6	YES	YES	YES	Pull And Push	YES
22" x 8"	4-1/2" If Box-box	6	YES	YES	YES	Pull And Push	YES
24" x 8"	4-1/2" If Box-box	6	YES	YES	YES	Pull And Push	YES
26" x 8"	3-1/2" If Box-box	6	YES	YES	YES	Pull And Push	YES
28" x 8"	4-1/2" If Box-box	6	YES	YES	YES	Pull And Push	YES
30" x 8-1/2"	5-1/2" Fh Box-box	6	YES	YES	YES	Pull And Push	YES
32" x 8-1/2"	5-1/2" Fh Box-box	6	YES	YES	YES	Pull And Push	YES
34" x 8-1/2"	5-1/2" Fh Box-box	6	YES	YES	YES	Pull And Push	YES
36" x 8-1/2"	5-1/2" Fh Box-box	6	YES	YES	YES	Pull And Push	YES
38" x 12"	5-1/2" Fh Box-box	8	YES	YES	YES	Pull And Push	YES
40" x 12"	5-1/2" Fh Box-box	8	YES	YES	YES	Pull And Push	YES
42" x 12"	5-1/2" Fh Box-box	8	YES	YES	YES	Pull And Push	YES
44" x 12"	5-1/2" Fh Box-box	8	YES	YES	YES	Pull And Push	YES
48" x 12"	Made To Order	8	YES	YES	YES	Pull And Push	YES

TRICONE HOLE OPENER



Diameter (in)	Connection
6" TRICONE HOLE OPENER	2-3/8" REG BOX - BOX
8" TRICONE HOLE OPENER	2-3/8" REG BOX - BOX
8" TRICONE HOLE OPENER	600 BOX - PULL TAB
10" TRICONE HOLE OPENER	2-3/8" REG BOX - BOX
10" TRICONE HOLE OPENER	2-3/8" REG BOX-SWIVEL
10" TRICONE HOLE OPENER	2-3/8" IF PIN X 3-1/2" REG BOX
10" TRICONE HOLE OPENER	2-7/8" REG BOX - BOX
10" TRICONE HOLE OPENER	3-1/2" REG BOX - BOX
12" TRICONE HOLE OPENER	2-3/8" REG BOX - BOX
12" TRICONE HOLE OPENER	2-3/8" REG BOX-SWIVEL
12" TRICONE HOLE OPENER	2-7/8" IF BOX - 3-1/2" REG BOX PULL
12" TRICONE HOLE OPENER	2-7/8" IF PIN-BOX
12" TRICONE HOLE OPENER	3-1/2" REG BOX - BOX
12" TRICONE HOLE OPENER	3-1/2" IF PIN-BOX
12" TRICONE HOLE OPENER	600 BOX - PULL TAB
12" TRICONE HOLE OPENER	700 BOX - PULL TAB
14" TRICONE HOLE OPENER	2-3/8" REG BOX-SWIVEL
14" TRICONE HOLE OPENER	2-7/8" IF BOX-BOX
14" TRICONE HOLE OPENER	3-1/2" REG BOX - BOX
18" TRICONE HOLE OPENER	2-3/8" REG BOX - PULL TAB
18" TRICONE HOLE OPENER	2-3/8" REG BOX-SWIVEL
18" TRICONE HOLE OPENER	2-7/8" IF BOX - BOX
18" TRICONE HOLE OPENER	3-1/2" REG BOX - BOX
18" TRICONE HOLE OPENER	3-1/2" IF BOX - BOX
18" TRICONE HOLE OPENER	5-1/2" FH BOX - BOX
18" TRICONE HOLE OPENER	700 BOX - PULL TAB
20" TRICONE HOLE OPENER	2-7/8" REG PIN X BOX

Diameter (in)	Connection
20" TRICONE HOLE OPENER	3-1/2" REG BOX - BOX
20" TRICONE HOLE OPENER	3-1/2" IF BOX - BOX
20" TRICONE HOLE OPENER	4-1/2" IF BOX - BOX
21" TRICONE HOLE OPENER	7-5/8" REG BOX - 6-5/8" REG BOX
22" TRICONE HOLE OPENER	3-1/2" REG BOX - BOX
24" TRICONE HOLE OPENER	3-1/2" REG BOX - BOX
26" TRICONE HOLE OPENER	4-1/2" IF BOX - BOX
28" TRICONE HOLE OPENER	4-1/2" IF BOX - BOX
30" TRICONE HOLE OPENER	4-1/2" IF BOX - BOX
32" TRICONE HOLE OPENER	4-1/2" IF BOX - BOX
33" TRICONE HOLE OPENER	4-1/2" FH BOX - BOX
37" TRICONE HOLE OPENER	4-1/2" FH BOX - BOX
38" TRICONE HOLE OPENER	4-1/2" FH BOX - BOX
42" TRICONE HOLE OPENER	6-5/8" FH DS BOX-BOX
48" TRICONE HOLE OPENER	6-5/8" REG BOX-BOX



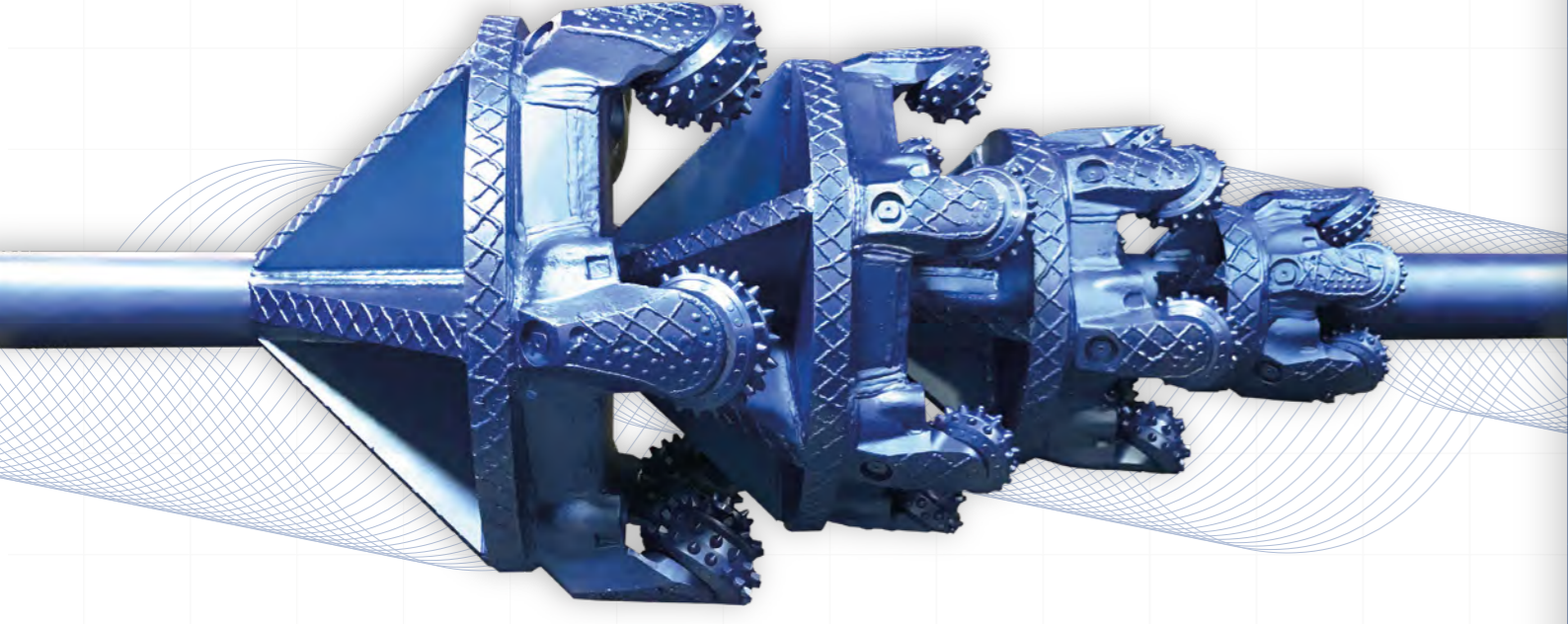

DTH HOLE OPENERS

CHRISTMAS TREE HOLE OPENERS

Designed to open a pilot bore to the final diameter in one pass.

Christmas Tree Reamers are designed and manufactured for large HDD rigs, tunnel boring and road crossing machines.

- Custom designed and manufactured to your requirements
- Final diameter in 1 pass – save time and money
- Push casing in directly behind the hole opener.

6" Range	
Shank	Size
QL60	2" x 6"
QL60	4-1/2" x 8"
QL60	130mm x 205mm
QL60	5-3/4" x 8"
QL60	5-3/4" x 10"
QL60	6" x 8"
QL60	6" x 10"
QL60	8" x 10"
QL60	8" x 12"
QL60	9-1/2" x 12"
QL60	10" x 12"
DHD360	6" x 8"
DHD360	6" x 8-1/2"
DHD360	6" x 10"
DHD360	8" x 10"
DHD360	8" x 12"
SD-6	4-1/4" - 8"
SD-6	4-1/4" - 10"
SD-6	6" x 8"
SD-6	6" x 10"
SD-6	8" x 10"
SD-6	8" x 12"

8" Range	
Shank	Size
QL80	4-3/4" x 8"
QL80	5-7/8" x 9"
QL80	6" x 8"
QL80	6" x 10"
QL80	8" x 10"
QL80	8" x 12"
DHD380	6" x 8"
DHD380	6" x 10"
DHD380	6" x 12"
DHD380	160mm x 300mm
DHD380	8" x 10"
DHD380	8" x 12"
SD-8	6" x 8"
SD-8	6" x 10"
SD-8	8" x 10"
SD-8	8" x 12"
SD-8	8-1/2 x 12-1/4"

12" Range	
Shank	Size
QL120	8" x 12"
DHD112	8" x 12"
SD-12	7-1/4" x 18"
SD-12	8" x 12"
SD-12	12-1/4" x 17-1/2"
SD-12	15" x 20"

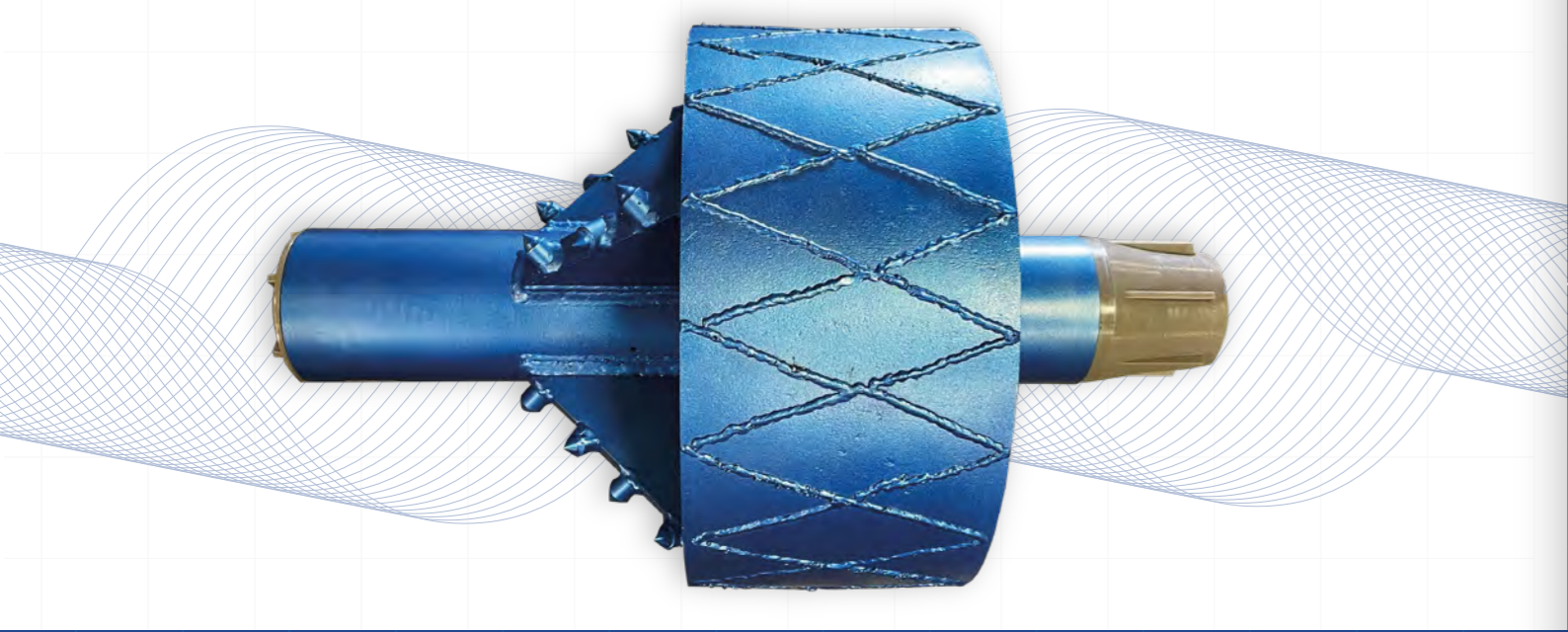

STABILIZERS

Stabilizers help keep the bore central and concentric by supporting your reamer or hole opener. Infinity Stabilizers come with hard facing and back out cutters as standard, and are manufactured in our Benton, Illinois facility.

Diameters are available from 12" to 32" with a wide range of thread connections.



SUBS

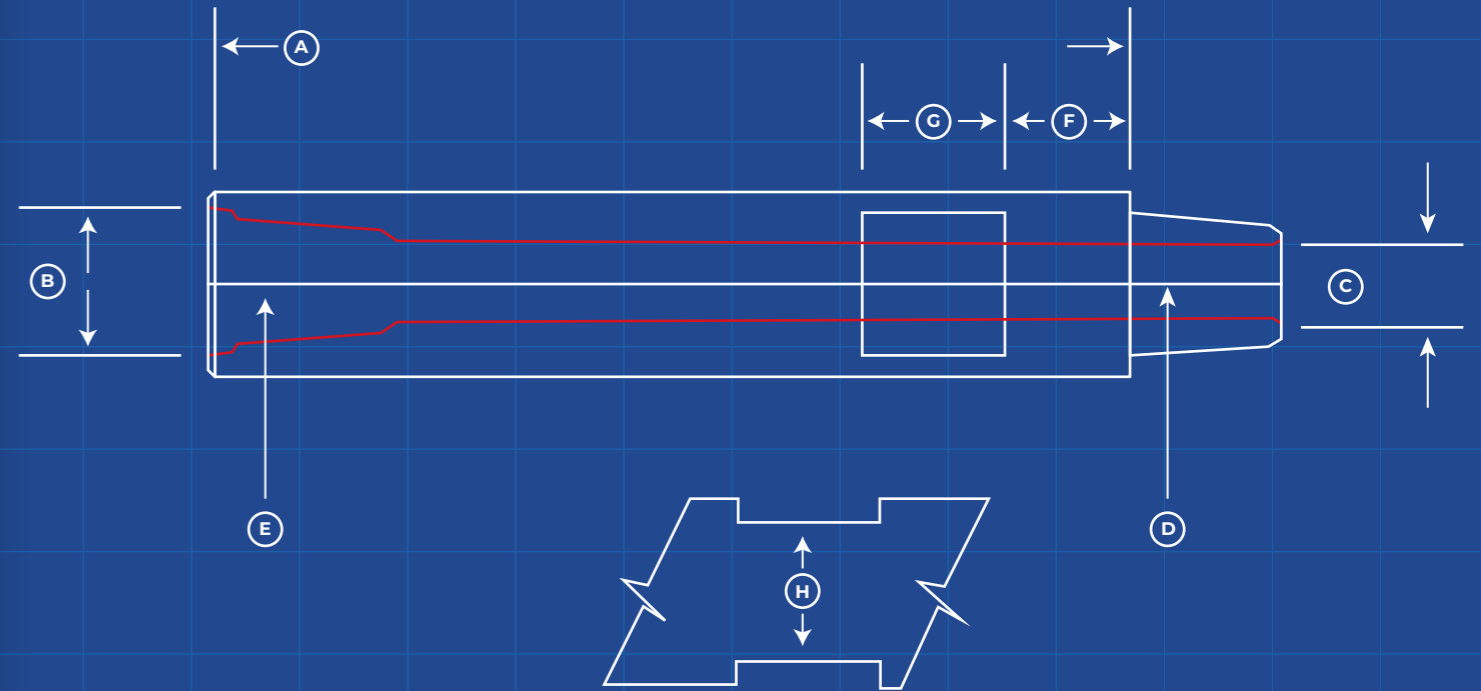

We offer a wide range of subs. If you know the sub you require, then please contact Infinity with the following information:

- A** - Shoulder to Shoulder length
- B** - Outside Diameter
- C** - Inside Diameter
- D** - Connection 1 (e.g. 2-7/8" API REG PIN)
- E** - Connection 2
- F** - Distance from Connection to Flats
- G** - Length across Flats
- H** - Width across Flats

If you are unsure on any of the above, please contact Infinity for help with choosing the correct sub for your requirements.

FOR CUSTOM BUILDS PLEASE CONTACT US +1 618 439 4042

APPENDIX

- PDC Bit Blade Guidelines
- PDC Nomenclature
- PDC Operational Guidelines

PDC BIT BLADE COUNT GENERAL GUIDELINES

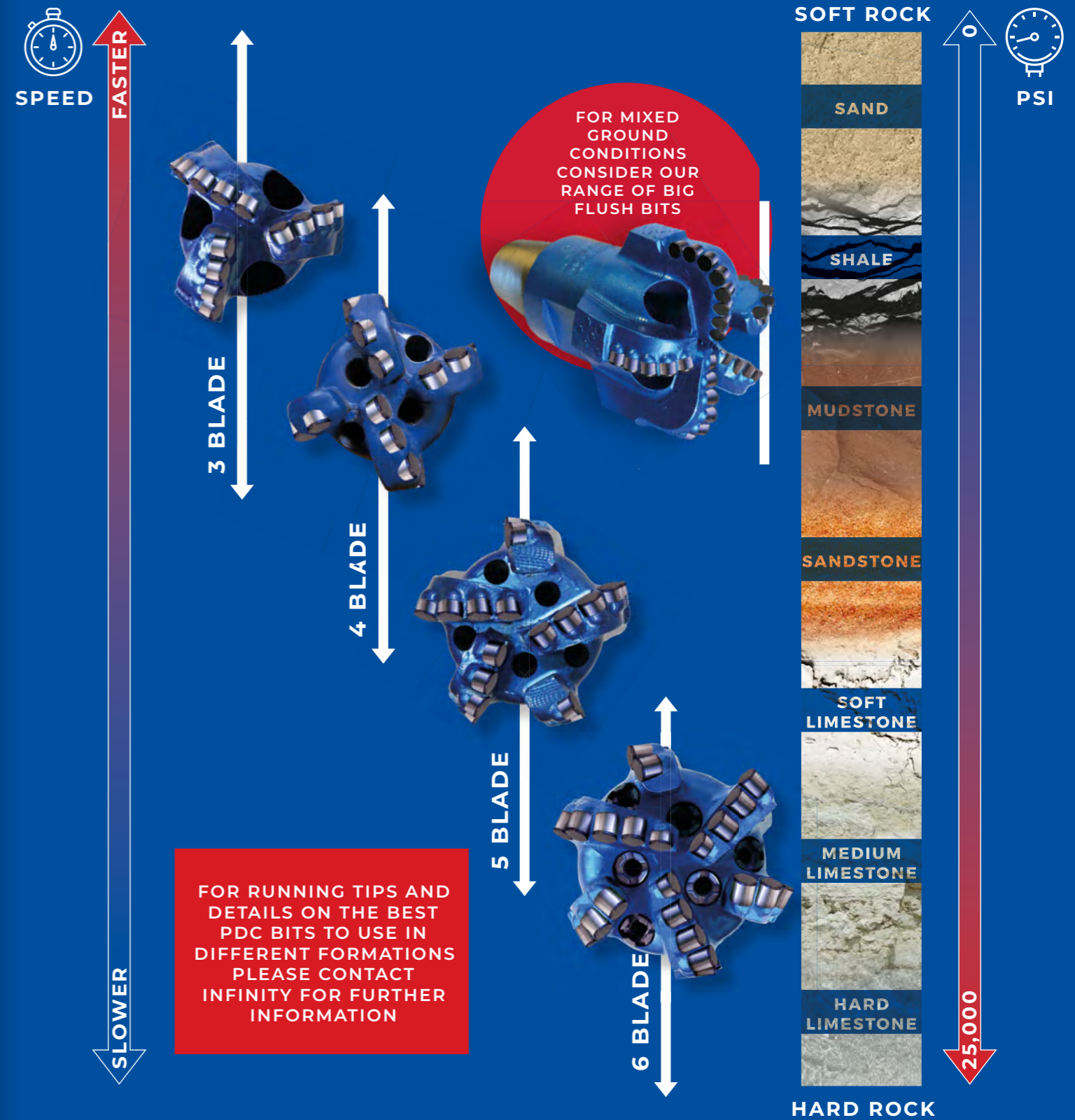

PDC NOMENCLATURE

- 1. Body Material:**
Alloy Steel = S
Other = O
- 2. Blade Count:**
3 = 3
4 = 4
5 = 5
6 = 6
7 = 7
8 = 8
9 = 9
- 3. Diamond Cutter Size:**
8mm = 8
10mm = 10
12mm = 13
16 mm = 16
19mm = 19
- 4. Diamond Cutter Class:**
Premium Plus = A
Premium = B
Standard = C
- 5. Number of Nozzle Ports:**
1 = RC
2 = 2
3 = 3
4 = 4
5 = 5
6 = 6
7 = 7
8 = 8
9 = 9
- 6. Row Design**
Double Row = D
Single Row = S
- 7. Backout Cutters Style:**
Backout Cutter = B
No Backout Cutter = O
- 8. Wear Protection:**
Wear Protection = W
No Wear Protection = O



Example

Type: S616A6SOW

S = Alloy Steel
6 = Blade Count
16 = Diamond Cutter Class
A = Diamond Cutter Class
6 = Nozzle Ports
S = Single Row
O = Backout Cutters Style
W = Wear Protection

PDC Operational Guidelines



PDC OPERATIONAL SUMMARY

Operational Summary

- Minimum RPM should be 60 to 80 RPM
- Maximum weight on Bit (WOB) – 3,000 lb per Inch diameter. E.g. 6" bit is 18,000 lb.
- Drilling Fluid Flow Rate
 - 20 GPM up to 5"
 - 30 GPM from 5" up to 5 7/8"
 - 40 GPM from 5 7/8" up to 7 7/8"

Bit Preparation

- Handling Fixed cutter PDC Bits
- Care needs to be taken with the Diamond cutting elements
- Always place bit on Softer surface for example wood, rubber mat, plastic

Installation of Nozzles

- Nozzle holes should be inspected and free of debris before installation
- Install Seal into the bottom of nozzle port while insuring they remain flat on the sealing surface
- Thread lock should be applied to all threads of nozzles and tightened with Nozzle Wrench

Make-up Torque

- Visually inspect thread pin for any debris
- Apply anti seize thread compound
- Make up once in rig to recommended API torque spec

NOTES.

PDC Entry into existing Hole

- Upon re-entry of an existing hole one should see an increase on torque as well as WOB which will indicate either contact with bottom of hole or pre-existing cuttings.
- PDC bits usually show an increase of torque before WOB appears
- NOTE: ALWAYS AVOID HIGH WOB WHEN IN OLD CUTTINGS AS THIS WILL CAUSE BIT BALLING.
- As soon as previous cuttings have been reached continue to rotate to the bottom of hole at full circulation until certain driller has reached the true bottom of the hole.
- WOB should not exceed 1,000 lbs per inch of bit at an rotational rate of 60-80 RPM.

Reaming - Tripping in the Hole

- Trip slowly any problem areas in the hole while washing plenty of drilling fluid and/ or reaming if necessary. If major hole issues are present a separate cleanup run to help straighten the hole may be necessary.
- Please remember while tripping the hole PDC bit are susceptible to damage especially cutter damage.
- Bits with smaller junk slots (groove between cutter blades) may produce surge pressures due to the restrictive space.
- Pumping drilling fluid downhole can help with hang ups as well as flushing the junk slots clean for ease of retraction of the bit.
- Recommendation is to ream 80-90ft. at reaming speed with full circulation.
- Trip back out.

Please note this document is intended as a summary for PDC Operational use, please always consult Infinity Tool MFG personnel before operating a PDC bit for the first time. For technical help please call +1 618 439 4042.

 infinitytoolmfg

 infinitytoolmfg

 infinitytoolmfg

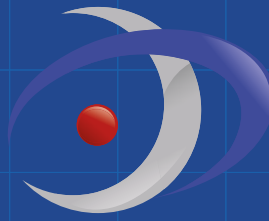

INFINITY[®] TOOL MFG.

11648 Skylane Drive, Benton IL 62812

1-888-838-6657
(+1) 618 439 4042

sales@infinitytoolmfg.com
www.infinitytoolmfg.com